

**Note: If fixing to a timber framed wall suitable cavity fixings must be used,**

**4. Fit wall brackets to the wall** using No. 10 x 2" long countersunk woodscrews. The holes for grub screws in the wall brackets must face outwards, (Figs. 2 & 4), or inwards if the shower screen is to swing into the bath (Fig. 3).

**5. The levelling sleeves in the wall brackets** must be carefully lined up using a suitable straight edge in contact with all four levelling sleeves. The levelling sleeves can be screwed in or out until all are in an accurate straight line. Make allowance for the possibility of the wall being out of true. Lock the positions of the levelling sleeves using the grub screws in the wall brackets.

**6. Fix wall hinges** over wall brackets and secure with the M6 x 16 long countersunk screws.

**7. The screen to bath seal** at the bottom

of the shower screen glass has two blades. Only one blade is necessary and the blade at the same side of the glass as the hinge back plate should be removed using a sharp knife.

**8. Four pivot bushes must be inserted** into each hinge assembly - two in the screen hinge and two in the wall hinge as shown in Fig. 4.

**9. Offer the shower screen glass** up to the wall hinges and insert the pivot pins. The holes in the underside of the wall hinges should be sealed using the hole plugs (Fig. 4).

**10. If the shower screen does not fit** on the bath correctly the shower screen glass and wall hinges will have to be removed so that the levelling sleeves in the wall brackets can be re-adjusted, (see 5 above).

**CLEANING**

Use a clean cloth and mild liquid soap and polish with a soft dry duster. No abrasive powders, detergents or polishes should be used for cleaning shower screens.

# RIALTO BATH SHOWER SCREEN



*Ideal Standard*

Ideal-Standard Limited  
The Bathroom Works  
National Avenue  
Kingston upon Hull  
HU5 4HS  
England  
Telephone: (01482) 346461  
Telefax: (01482) 445886.

**CUSTOMER CARE HELPLINE**  
**0870 1296081**  
**FAX LINE 01482 499611**  
**email@ ukcustcare@aseur.com**

Ideal Standard pursues a policy of continuing improvement in design and performance of its products. The right is, therefore, reserved to vary specifications without notice.

Ideal Standard (UK) Ltd.

2559 06/03

## Installation Instructions

*Ideal Standard*

## INSTALLATION

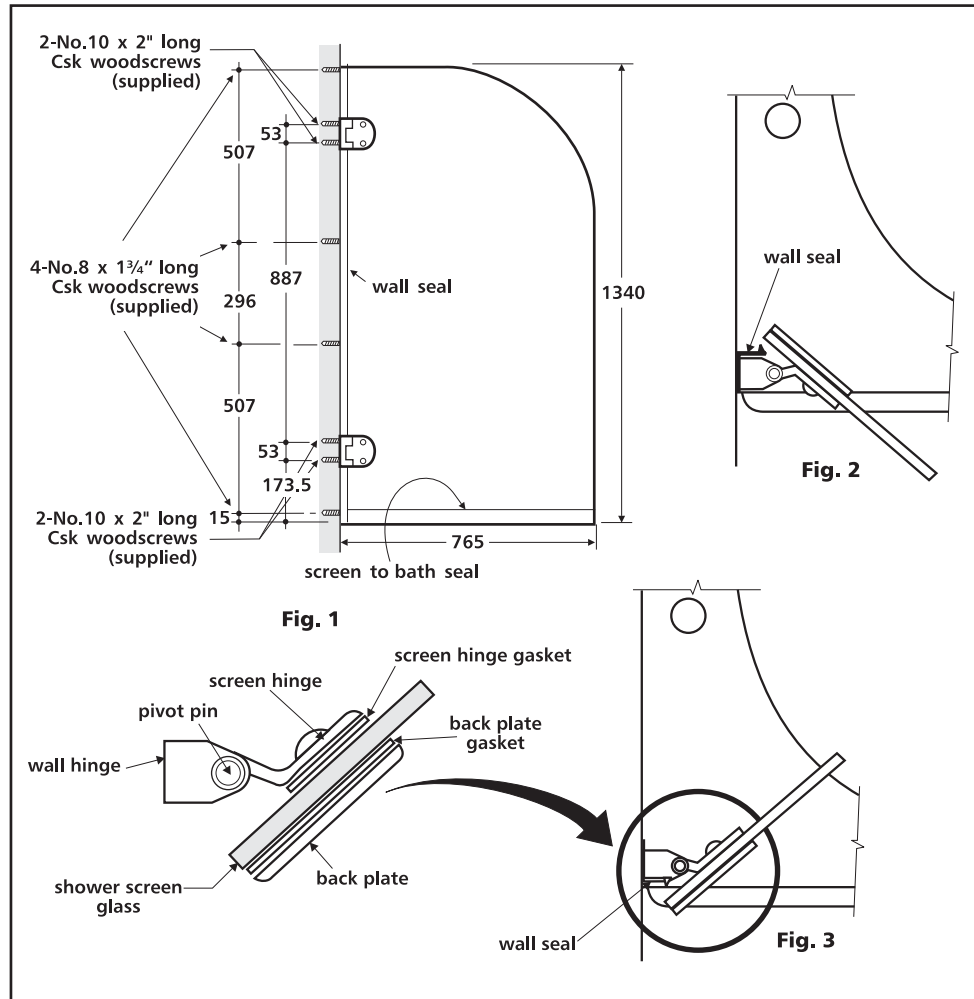

The Rialto bath shower screen is supplied with the screen to bath seal already fitted. The wall seal is packed with the shower screen. The two hinge assemblies are packed separately to be fitted to the shower screen glass on site. The hinge assemblies are designed so that the glass will swing outwards (Fig. 2) away from the bath.

However there may be instances where there is an obstruction or doorway adjacent to the screen end of the bath and it is possible to fit the screen to swing into the bath by reversing the screen hinges and back plates see Fig. 3. Dimensions of the Rialto bath shower screen are shown in Fig. 1.

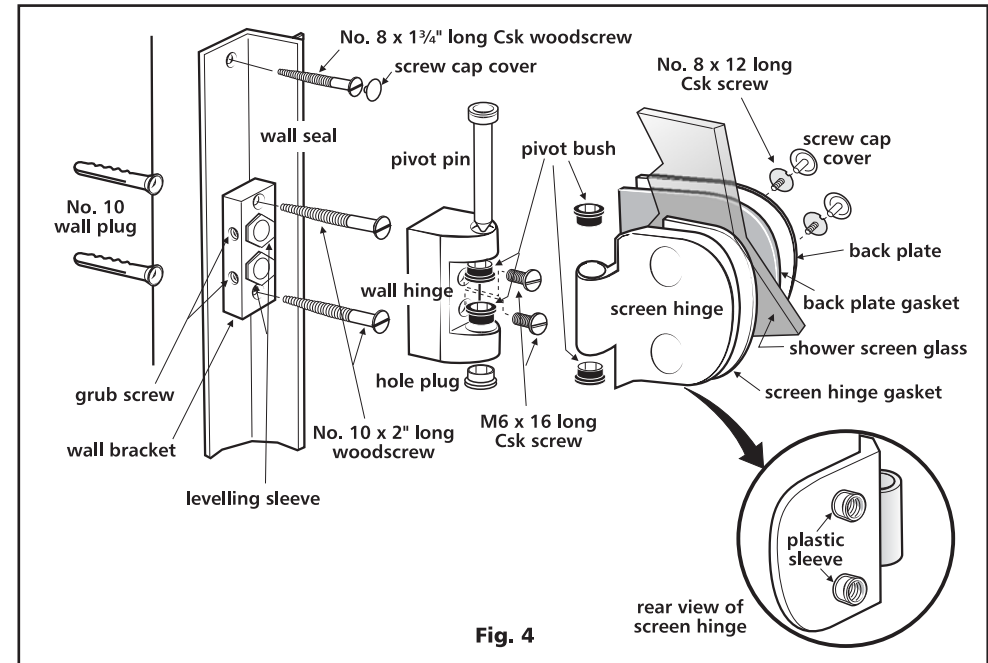

**Note: Do not stand the shower screen glass on its screen to bath seal located at the bottom of the glass.**

**1. Fix the two hinge assemblies** to the shower screen glass using screen hinge and screen hinge gasket in front of the glass and back plate gasket and back plate behind the glass, (Fig. 4). Plastic sleeves must be fitted to the screen hinges as shown in Fig. 4. The screen hinge and back plate are connected using M8 x 12 long countersunk screws with screw cap covers, (Fig. 4). For the shower screen to swing into the bath the wall seal, the screen hinge, screen hinge gasket, back plate and back plate gasket have to be reserved. The pivot pin enters the hinge assembly from the top, (Figs. 3 & 4).

**2. The wall seal is supplied cut to length** and fixing holes are pre-drilled. Position the wall seal on the wall with the bottom edge touching the bath and mark positions for all holes. Ensure that the wall seal is not positioned incorrectly due to obstruction by the bath sealant or sealing strip. Do not stand in the bath or rest on the rim when positioning the wall seal.

**3. Drill and plug wall** for the four No. 8 x 1 3/4" long countersunk wood screws for wall seal and the four No. 10 x 2" countersunk wood screws for the wall brackets. The positions for the fixing screws are shown in Fig. 1. Apply a suitable waterproof sealant to the wall seal and screw the wall seal to the wall to suit hinge position, (Figs. 2 & 3), and fit cap covers.