

Produced since: Aug. 2015

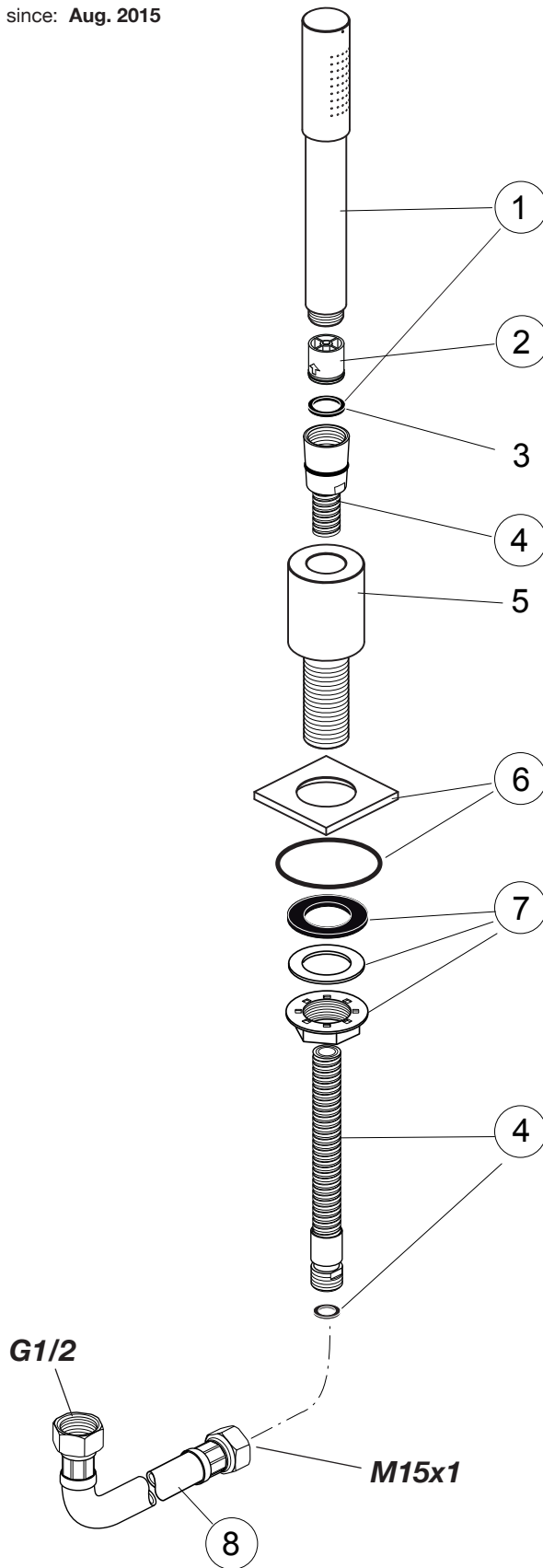

Rim mounted hand spray  
with holder and flex.hoses  
chrome

**A6466AA**

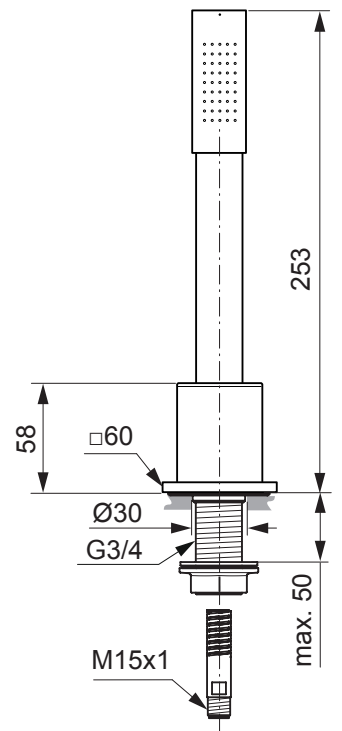

Pos.	Description	Part-Number	Qty.	Pos.	Description	Part-Number	Qty.
1	Hand shower w. Logo Sottini	<b>A 860 991 AA</b>	1 Set	6	Plate w. o-ring Ø 50 x 3	<b>F 960 774 AA</b>	1 Set
2	Non return valve DW15	<b>N 042 977 NU</b>	1 pcs	7	Fixation kit shower-holder	<b>H 960 279 NU*</b>	1 Set
3	Washer Ø 20,8 x 14,5 x 2,5			8	Flex. hose G1/2 x 600mm	<b>H 960 185 NU</b>	1 pcs
4	Shower hose G1/2 -M15x1	<b>F 960 817 AA</b>	1 pcs				
5	Holder for hand shower						

\* Universal-Set (not all parts needed)